

**Recordall® Bronze
Disc Meters**

**For Potable and Reclaimed Water
Models LP, 25, 35, 55, and 70**

**Repair
Parts**

5/8", 5/8" x 3/4"

**Model LP
BRONZE**



**Model 25
BRONZE**



3/4"

**Model 35
BRONZE**



1"

**Model 55
BRONZE**



1"

**Model 70
BRONZE**



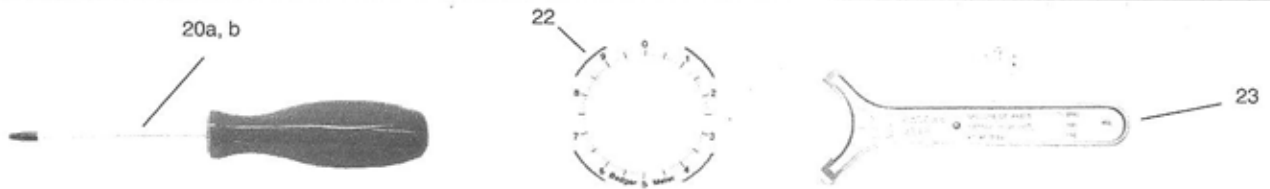
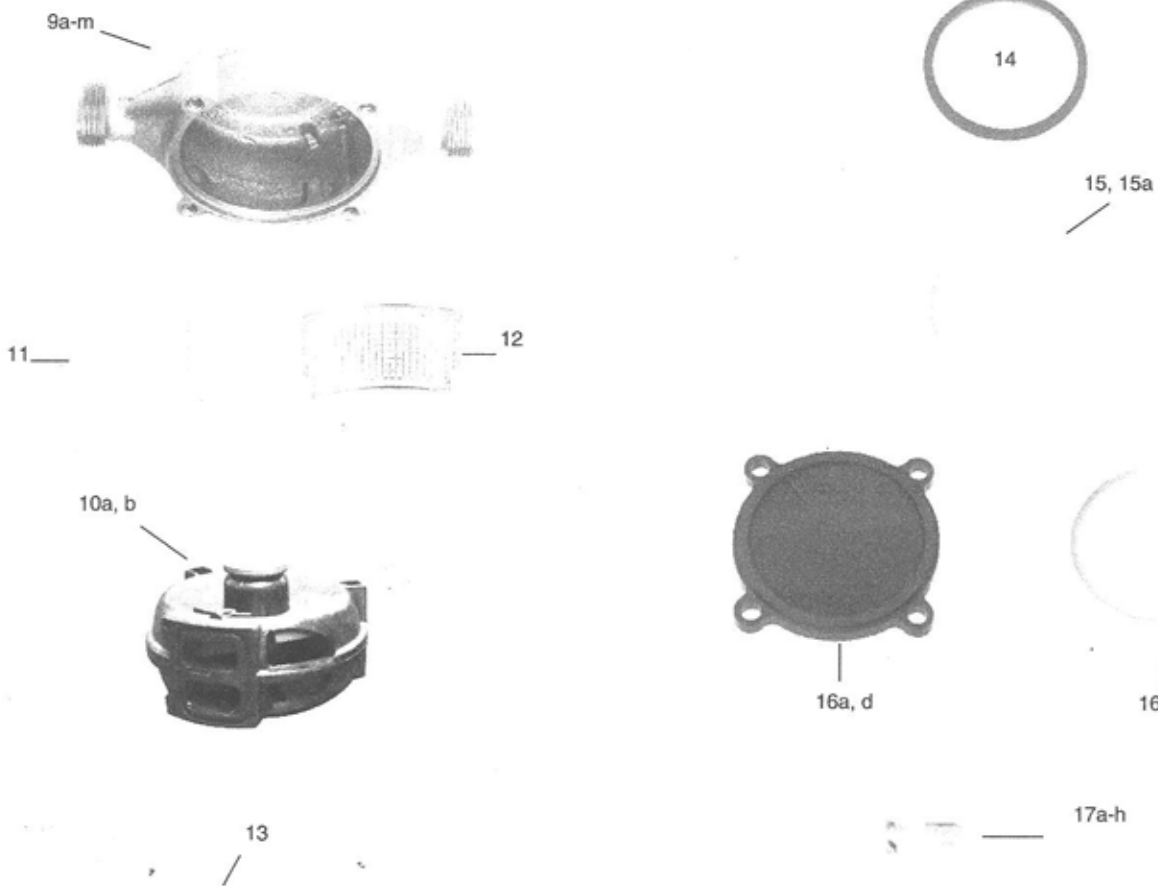
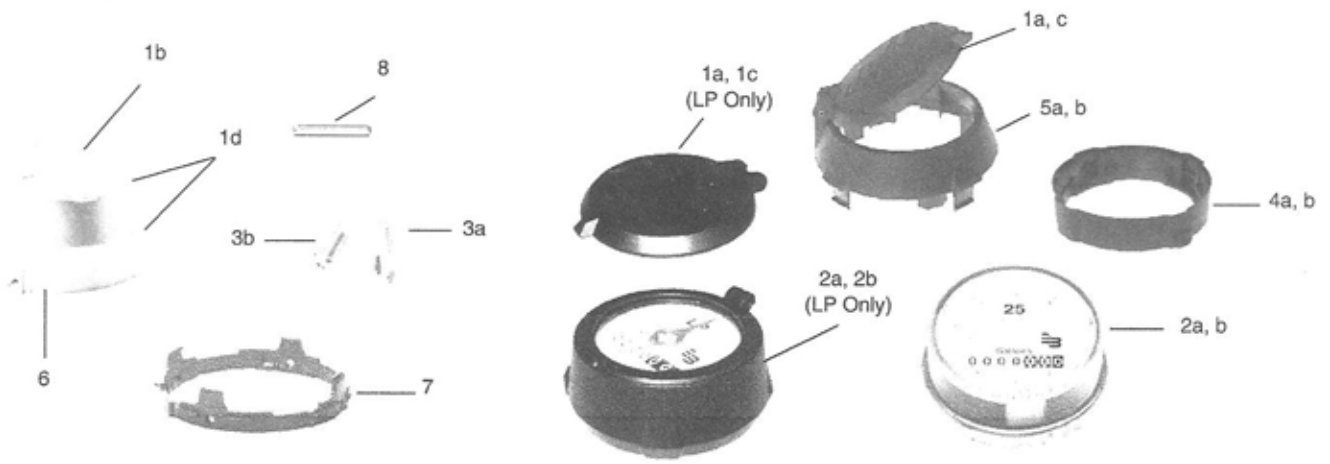

NOTE: See Repair Parts Price List S-3541. Give model size, complete part description, and part number.

METER PARTS

Item No.	Name of Part	Model LP	Model 25	Model 35	Model 55	Model 70
1a	Register Flat Lid (Plastic)	65814-001	62278-001	62278-001	62278-001	62278-001
1b	Register Flat Lid (Bronze)	62353-001	62353-001	62353-001	62353-001	62353-001
1c	Register Flat Lid (Purple) "RECLAIMED"	65814-002	62740-001	62740-001	62740-001	62740-001
1d	Register Flat Lid and Shroud (Bronze)	62616-001	62616-001	62616-001	62616-001	62616-001
2a	Register Assembly: U.S. Gallons	65801-001	63961-002	63961-060	63961-153	63961-068
	Cubic Feet	65801-002	63961-003	63961-061	63961-154	63961-069
	Imperial Gallons	65801-004	63961-016	63961-074	63961-156	63961-075
	Cubic Meters	65801-003	63961-007	63961-062	63961-155	63961-070
2b	Reg. Assy. "RECLAIMED": U.S. Gallons	65801-005	63961-088	63961-089	63961-157	63961-090
	Cubic Feet	65801-006	63961-091	63961-092	63961-158	63961-094
2a	Register Assembly: U.S. Gallons	63961-159	-----	-----	-----	-----
	Model LP only Cubic Feet	63961-160	-----	-----	-----	-----
	in Model 25 Imperial Gallons	63961-162	-----	-----	-----	-----
	Design Style Cubic Meters	63961-161	-----	-----	-----	-----
3a	Screw Tamper-resistant, standard (for Local Register)	62335-001	62335-001	62335-001	62335-001	62335-001
3b	Tamper Resistant TORX® Seal Screw (for Local Register)	62516-001	62516-001	62516-001	62516-001	62516-001
3c	Tamper Resistant TORX® Seal Screw (for Generator Register not shown)	-----	62516-002	62516-002	62516-002	62516-002
3d	Screw Tamper-resistant, standard (for Generator Register not shown)	-----	62624-001	62624-001	62624-001	62624-001
4a	Plastic Shroud (Bottom Half)	-----	62279-001	62279-001	62279-001	62279-001
4b	Plast. Shroud (Bot. Half) "RECLAIMED"	-----	62279-003	62279-003	62279-003	62279-003
5a	Plastic Shroud (Top Half)	-----	62280-001	62280-001	62280-001	62280-001
5b	Plastic Shroud (Top Half) "RECLAIMED"	-----	62280-002	62280-002	62280-002	62280-002
6	Bronze Shroud (For Flat Lid)	62442-001	62442-001	62442-001	62442-001	62442-001
7	Pls. Insert for Flat Lid Brz. Shroud	62455-001	62455-001	62455-001	62455-001	62455-001
8	Flat Lid Hinge Pin	59568-003	59568-003	59568-003	59568-003	59568-003
9a	Housing, 5/8" x 7-1/2"	-----	62303-003	-----	-----	-----
9b	Housing (BIA), 5/8" (LP-BIA)	65803-003	62303-021	-----	-----	-----
9c	Housing, 5/8" x 3/4", 5/8" Bore	-----	62303-001	-----	-----	-----
9d	Housing (BIA), 5/8" x 3/4", 5/8" Bore (LP-BIA)	65803-001	62303-019	-----	-----	-----
9e	Housing (BIA), 3/4", 3/4" Bore (LP-BIA)	65803-002	62303-020	59807-006	-----	-----
9f	Housing, 3/4" - 7-1/2" LL, 3/4" Bore	-----	62303-002	59807-001	-----	-----
9g	Housing, 3/4" x 9"	-----	-----	59809-001	-----	-----
9h	Housing (BIA), 3/4" x 9"	-----	-----	59809-009	-----	-----
9i	Housing, 3/4" x 1" x 9"	-----	-----	59809-002	-----	-----
9j	Housing (BIA), 3/4" x 1" x 9"	-----	-----	59809-010	-----	-----
9k	Housing, 1"	-----	-----	-----	65615-001	58867-001
9l	Housing (BIA), 1"	-----	-----	-----	-----	58867-009
9m	Housing (BIA), 1"	-----	-----	-----	65615-003	-----
10a	Chamber Assy Plastic w/ Plastic Thrust Roller	65834-003	33334-009	33334-029	65553-003	33334-032
10a	Chamber Assy Plastic with w/ SS Thrust Roller	-----	-----	-----	-----	33334-016
10b	Chamber Assy Plastic for "RECLAIMED" Water	65834-004	33334-038	33334-040	65553-004	33334-042
11	Combined Strap and Screen	-----	64942-001	-----	-----	59186-001

(continued on next page)

METER PARTS (Continued)

Item No.	Name of Part	Model LP	Model 25	Model 35	Model 55	Model 70
12	Screen	-----	-----	59805-001	65619-001	-----
13	Chamber Retainer Strap	-----	-----	58540-001	58540-001	-----
14	Housing Gasket/O-ring	64083-014	11071-033	59782-001	65592-001	58769-001
15	Housing Bottom Liner (for Cast Iron)	-----	57800-001	59786-001	65618-001	58770-001
15a	Hsg Bottom Liner/Screen	65835-001	-----	-----	-----	-----
16a	Housing Bottom (Cast Iron)	65806-002	57799-001	59785-001	65654-001	59293-002
16b	Housing Bottom (Bronze)	-----	62635-001	59784-001	65617-001	59703-001
16b	Housing Bottom (BIA)	65805-003	-----	-----	65617-003	-----
16b	Housing Bottom (BIA)	-----	62635-005	59784-005	-----	59703-006
16c	Housing Bottom (Plastic not shown)	65808-001	64428-001	-----	-----	-----
16d	Housing Bottom (Cast Iron) "RECLAIMED"	65806-003	57799-003	59785-003	65654-003	59293-003
16e	Housing Bottom (Bronze) "RECLAIMED"	65805-004	62635-002	59784-002	65617-002	59703-002
17a	Housing Bolt (Plastic Closure)	-----	58396-001	-----	-----	-----
17b	Housing Bolt, Seal (Plastic Closure)	-----	58396-002	-----	-----	-----
17c	Housing Bolt Seal (Bronze/Iron Closure)	-----	59058-001	59058-001	59058-001	59733-001
17d	Housing Bolt (Bronze/Iron Closure)	-----	62777-001	62777-001	62777-001	-----
17e	Housing Bolt (Bronze Bolt)	-----	62260-001	62260-001	62260-001	55029-060
17f	Housing Bolt, Seal (Bronze Bolt)	-----	-----	-----	-----	25421-041
17g	Housing Bolt, (All Bottoms)	65857-001	-----	-----	-----	-----
17h	Housing Bolt, Seal (All Bottoms)	65858-001	-----	-----	-----	-----
19a	Washer (M70) Brz. Bott. 1989-97 Only (Stainless Steel Washer) Not Shown	-----	-----	-----	-----	24991-044
19b	Washer (M70) Brz. Bottom 1989-1997 Only (Bronze Washer Not Shown)	-----	-----	-----	-----	55260-016
20a	TORX® Seal Screw Driver & Bit (Stubby)	62658-001	62658-001	62658-001	62658-001	62658-001
20b	TORX® Seal Screw Driver & Bit (Long)	62658-003	62658-003	62658-003	62658-003	62658-003
21	TORX® Seal Screw Driver Bit (Not Illustrated)	62657-001	62657-001	62657-001	62657-001	62657-001
22	Register Test Ring	-----	62446-001	62446-001	62446-001	62446-001
23	Plastic Shroud Disassembly Tool	-----	62346-001	62346-001	62346-001	62346-001
	Chamber Assembly Service Parts:					
	"O" Ring for Plastic Chamber	64083-013	22650-045	22650-056	22650-060	22650-057
	"O" Ring for All Plastic Chamber	-----	64083-006	-----	-----	-----
	Thrust Roller (Plastic)	58965-001	58965-001	58965-001	65558-001	59652-001
	Thrust Roller (Stainless Steel)	-----	-----	-----	-----	59746-001
	Dovetail Thrust Roller Insert	-----	33342-000	59743-001	-----	11074-003

Recordall® is a registered trademark of Badger Meter, Inc. All other trademarks appearing in this document are the property of their respective entities.



Please see our Web site at
www.badgermeter.com
 for specific contacts.

Due to continuous research, product improvements and enhancements, Badger Meter reserves the right to change product or system specifications without notice, except to the extent an outstanding contractual obligation exists.



BadgerMeter, Inc.

P.O. Box 245036, Milwaukee, WI 53224-9536
 800-876-3837